



Job No.

Checking condition of poly V – belt and renewing	13 – 342
Removing, installing tensioning device	- 345

13-342 Checking condition of poly V-belt and renewing

Job No. of job texts and job values or standard
texts and flat rates 13-1202 - 13-4001

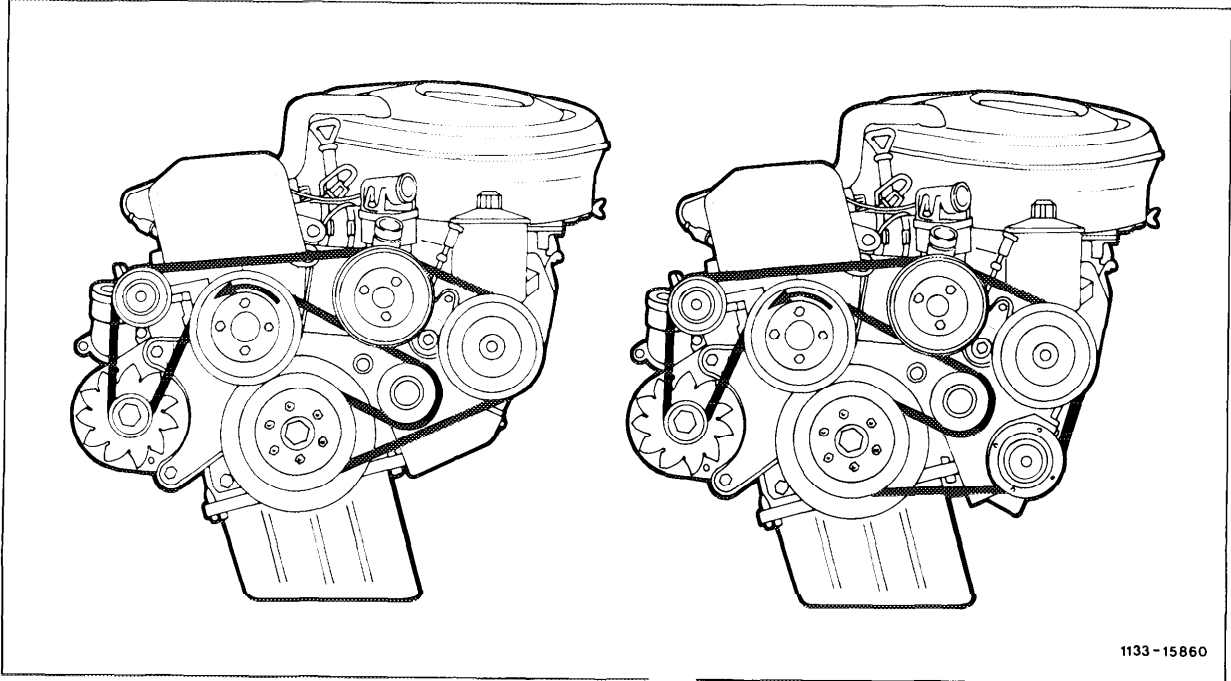

Checking

Hood	raise to vertical position (01-008).
Engine	crank (01-010).

Renewing

Viscous fan clutch	remove, install (20-312).
Poly V-belt	remove, install (steps 5 to 11).

Checking

- 1 Raise hood to vertical position (01-008).
- 2 Check V-belt. Mark V-belt with chalk at a clearly visible point.
- 3 Crank engine in stages (01-010), at the same time checking V- belt for signs of damage.
- 4 This operation is completed once the marking is again visible (one complete revolution of belt).

Patterns of damage

- 5 The V-belt must be renewed (to separate order) if the following patterns of damage exist:
Rubber knobs in base of belt (C),
dirt or grit embedded in belt (D).

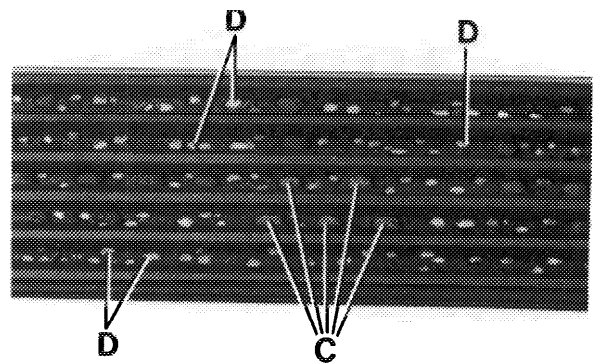

113-31547

- Wear to flank (F),
ribs are pointed - trapezoidal in shape when new (E) and strands visible in base of belt (G, brighter points).

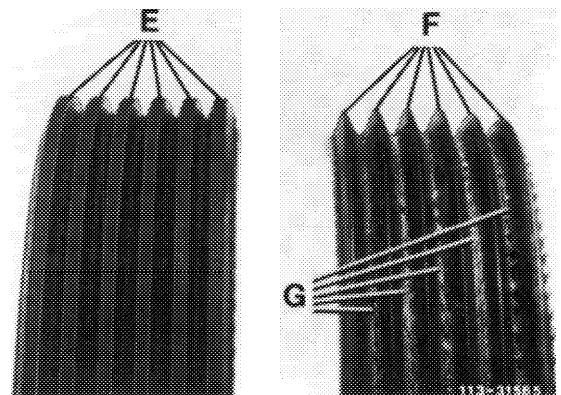

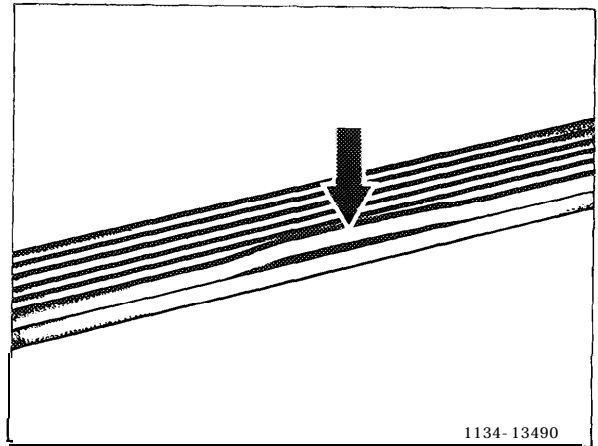

1134- 13490

Cracks across the ribs (H) and/or sections of ribs broken off (J).

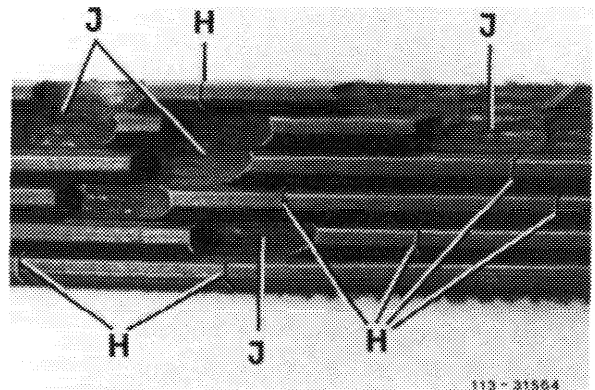

113 - 21364

Strand torn at the side (K) or outer strands frayed (L).

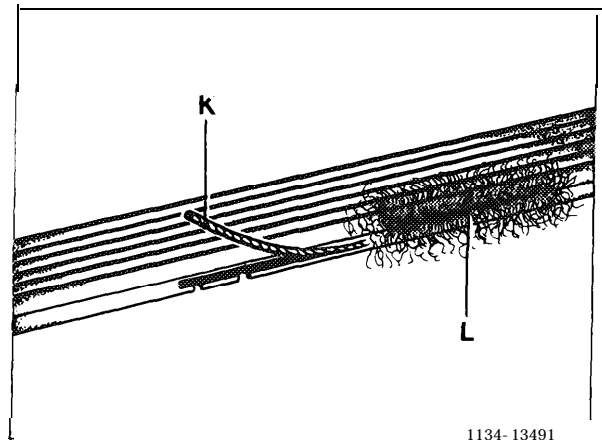

1134- 13491

Cracks (M) across the back.

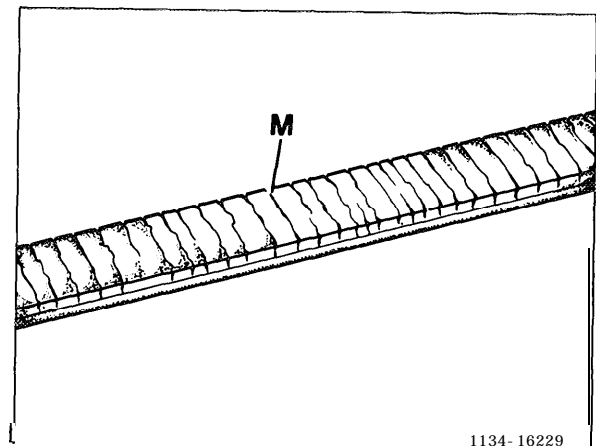

1134- 16229

Renewing

6 Remove viscous fan clutch (20-312).

7 Slacken bolt (16) approx. 1/4 - 1/2 turns. Release tensioning device with tensioning nut (5) (turn to the left) until the belt can be removed. Check belt pulley profiles and tensioning device for signs of damage and dirt, renew if necessary (e. g. worn bearing points of tensioning device, dents in the belt pulleys etc.).

8 Turn setting pointer (13) to the left and position to the first graduation mark (arrow).

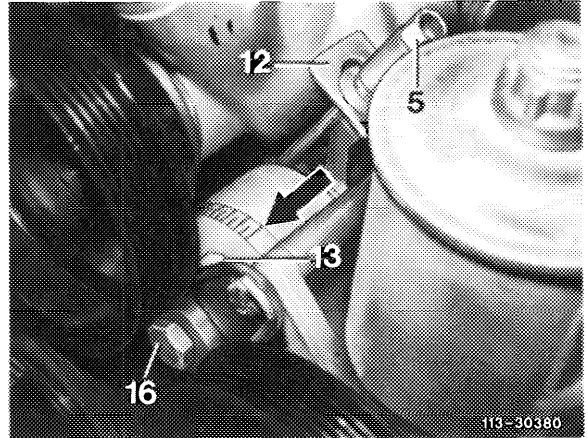

9 Fit on V-belt beginning in the numerical order of the running diagrams with tensioning pulley (1).

Note

Do not use belt wax or similar products.

Running diagram without refrigerant compressor:

Length of belt 2170 mm

Setting pointer/graduations 7

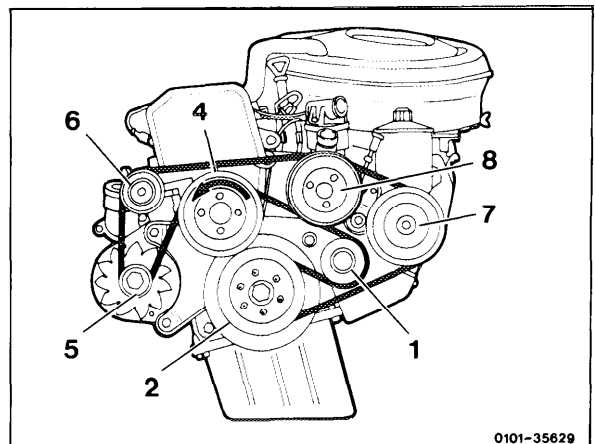

1	Tensioning pulley	6	Guide pulley
2	Crankshaft	7	Power steering pump
4	Fan	8	Coolant pump
5	Alternator		

Running diagram with refrigerant compressor:
 Length of belt 2255 mm
 Setting pointer/graduations 7

- | | |
|---|------------------------|
| 1 | Tensioning pulley |
| 2 | Crankshaft |
| 3 | Refrigerant compressor |
| 4 | Fan |
| 5 | Alternator |
| 6 | Guide pulley |
| 7 | Power steering pump |
| 8 | Coolant pump |

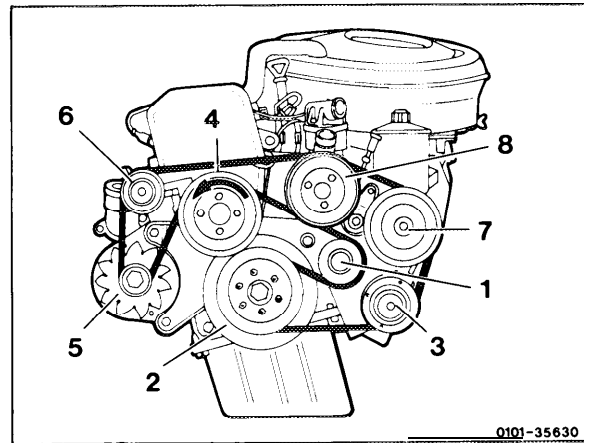

10 Turn tensioning nut (5) to the right until the setting pointer is positioned above the following graduations (arrow).

Engine without refrig. compr.	5th mark
Engine with refrig. compr.	7th mark

11 Tighten bolt (16) to 75 Nm (reference value).

Note

As from November 1986 the alternator is attached at the bottom to the bracket with a 13 mm collar bolt. If this collar bolt is removed, the V-belt can be slackened by swivelling the alternator without slackening the bolt (16).

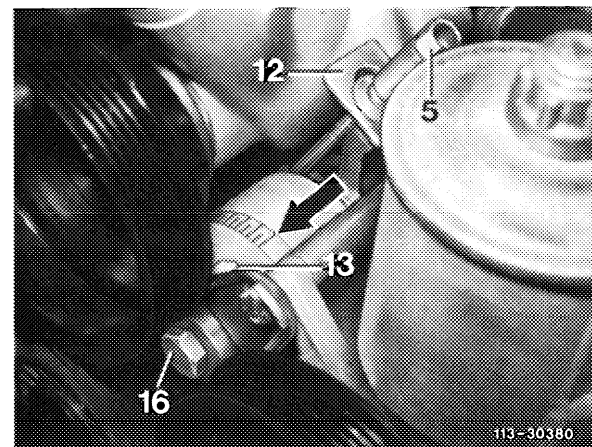

12 Check that the belt is correctly located on the belt pulleys.

13 Install in the reverse order.

13-345 Removing, installing tensioning device

Job No. of job texts and job values or standard
 texts and flat rates 13-1202 - 13-4001

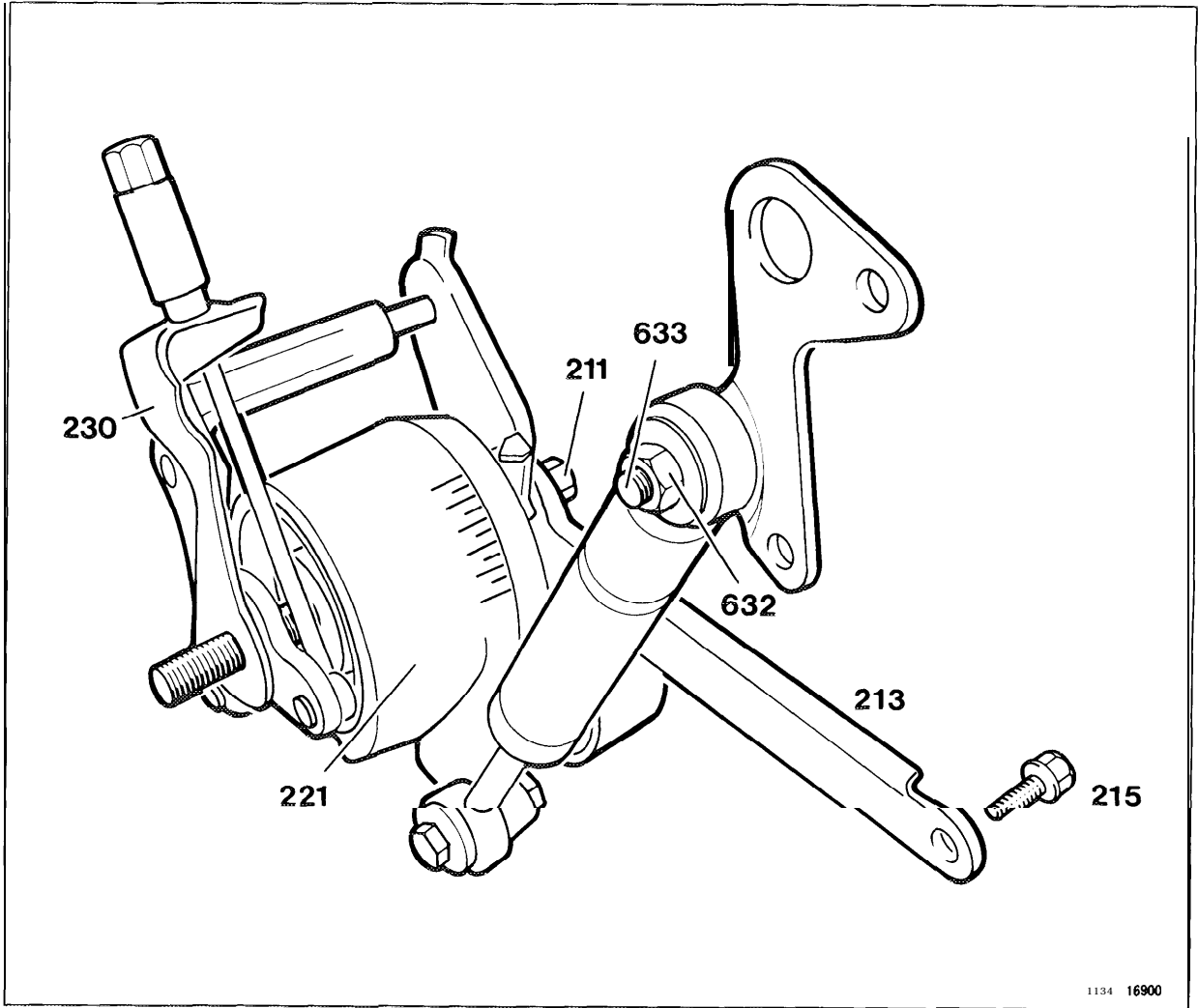

Air filter	remove, install (09-400).
Poly V-belt	remove, install (13-342).
Belt pulley of fan clutch, coolant pump, tandem pump	remove, install, 10 Nm (step 5).
Tensioning device (221)	remove, install, tightening torque for bolt (211) 75 Nm (steps 6 to 8).

Bracket (230)

Nut (632)

Bolt (215)

remove, install (steps 9 and 10).

screw down, withdraw bolt (633) (step 6).

unscrew, screw on, apply sealant
001 589 29 20 to mounting hole of
bracket (213) (step 7).

Removal. installation

- 1 Remove air filter (09-400).
- 2 Remove viscous fan clutch (20-312).
- 3 Slacken bolt (arrows).
- 4 Remove V-belt (13-342).
- 5 Unscrew bolts (arrows), tightening torque 10 Nm.
Take off belt pulleys of fan clutch (210),
coolant pump (273) and tandem pump (284).

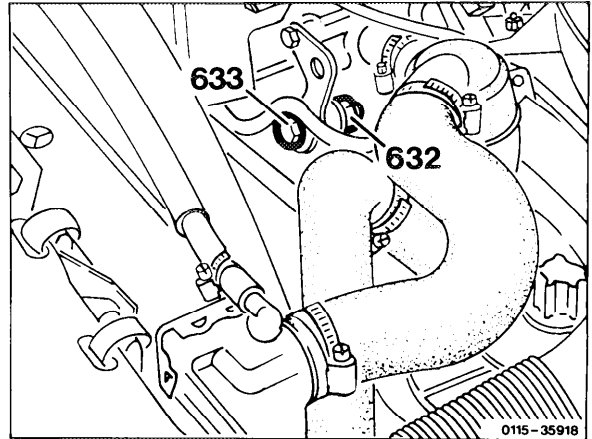

- 6 Screw down nut (632), withdraw bolt (633).

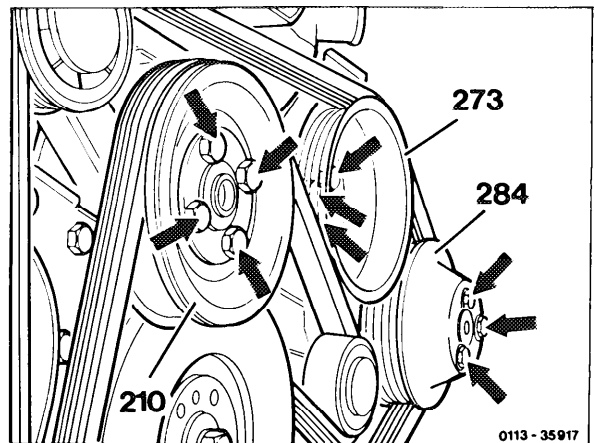

- 7 Unscrew bolts (211, 652, 651, 215).
Remove bracket (213).
Tightening torque for bolt (211) 75 Nm.

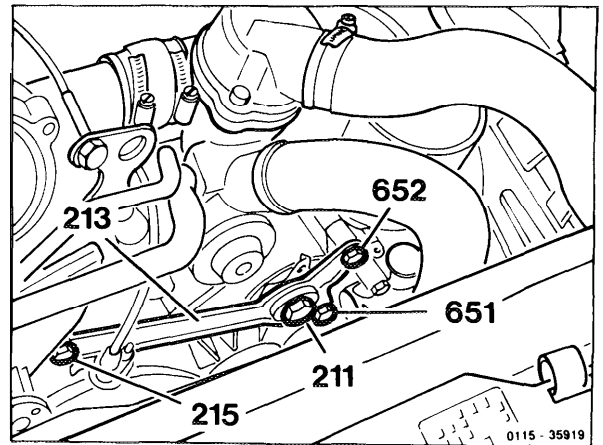

Installation instruction

Apply sealant 001 989 29 20 to the front and rear sides of the mounting hole (arrow) of the bracket (213).

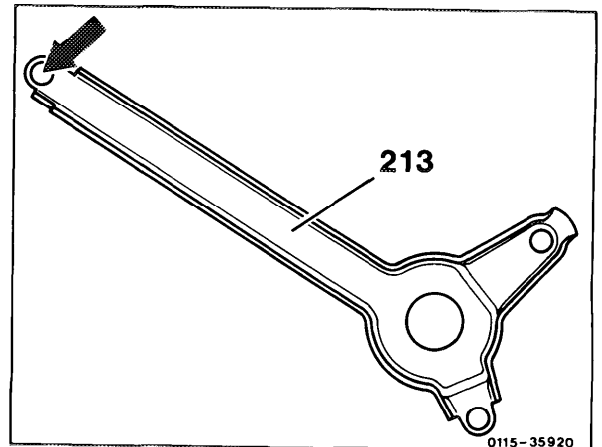

- 8 Take off setting pointer (219), carefully pull tensioning device (221) forward and remove.

Installation instruction

In the untensioned state, the setting pointer (219) must be aligned with the first graduation mark (arrow).

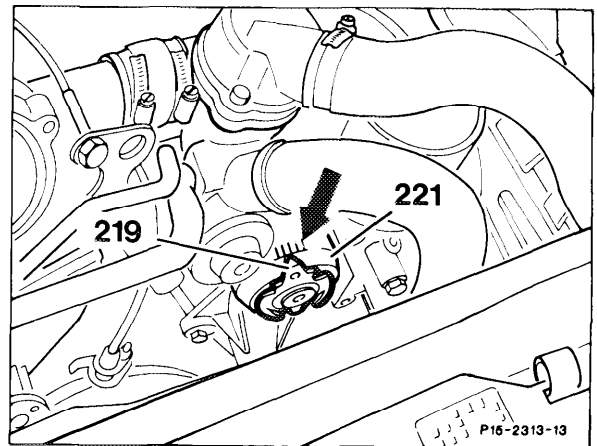

- 9 Unscrew bolts (277, 278).

- 10 Swivel tandem pump in direction of arrow.
Remove bracket (230).

- 11 Install in the reverse order.

